

PHILIPS

Lumea

SC1997





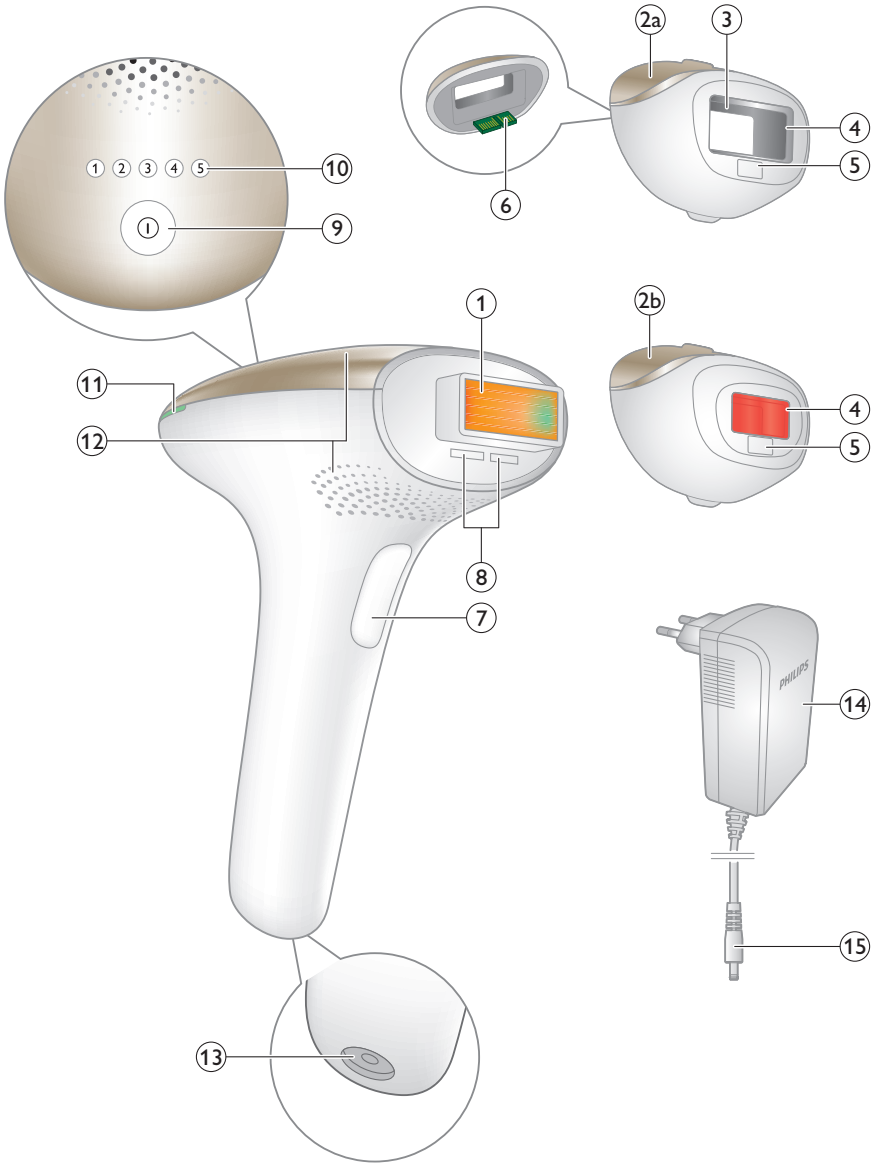

**English
Latviešu
Lietuviškai
Eesti**

Welcome

Welcome to the beauty world of Lumea! You are only a few weeks away from silky-smooth skin.

Philips Lumea uses Intense Pulsed Light (IPL) technology, known as one of the most effective methods to continuously prevent hair regrowth. In close cooperation with licensed dermatologists we adapted this light-based technology, originally used in professional beauty salons, for easy and effective use in the safety of your home. Philips Lumea is gentle and offers convenient and effective treatment at a light intensity that you find comfortable. Unwanted hairs are finally a thing of the past. Enjoy the feeling of being hair-free and look and feel amazing every day.

To fully benefit from the support that Philips offers, register your product at www.philips.com/welcome. For further information, please go to www.philips.com/lumea to find our experts' advice, tutorial videos and FAQs and make the most of your Lumea.

Device overview

- 1 Light exit window with integrated UV filter
- 2 Attachments
 - a Body attachment
 - b Precision attachment
- 3 Reflector inside the attachment
- 4 Integrated safety system
- 5 Skin tone sensor
- 6 Electronic contacts
- 7 Flash button
- 8 Opening for electronic contacts
- 9 On/off button
- 10 Intensity lights (1-5)
- 11 'Ready to flash' light
- 12 Air vents
- 13 Device socket
- 14 Adapter
- 15 Small plug

Who should not use Lumea? Contraindications

- Never use the device if you have skin type V and VI (You rarely to never sunburn, very dark tanning). In this case you run a high risk of developing skin reactions, such as hyperpigmentation and hypopigmentation, strong redness or burns.



- Never use the device if you are pregnant or breast feeding as the device was not tested on pregnant or breast feeding women.
- Never use the device if you suffer from any of the diseases listed below:

- If you have a skin disease such as active skin cancer, you have a history of skin cancer or any other localized cancer in the areas to be treated.
- If you have pre-cancerous lesions or multiple atypical moles in the areas to be treated.
- If you have a history of collagen disorder, including a history of keloid scar formation or a history of poor wound healing.
- If you have a history of vascular disorder, such as the presence of varicose veins or vascular ectasia in the areas to be treated.
- If your skin is sensitive to light and easily develops a rash or an allergic reaction.
- If you have infections, eczema, burns, inflammation of hair follicles, open lacerations, abrasions, herpes simplex, wounds or lesions and haematomas in the areas to be treated.
- If you have had surgery in the areas to be treated in the last three weeks.
- If you have epilepsy with flashlight sensitivity.
- If you have diabetes, lupus erythematoses, porphyria or congestive heart disease.
- If you have any bleeding disorder.
- If you have a history of immunosuppressive disease (including HIV infection or AIDS)
- Never use the device if you take any of the medications listed below:
 - If your skin is currently being treated with or has recently been treated in the past week with Alpha-Hydroxy Acids (AHAs), Beta-Hydroxy Acids (BHAs), topical isotretinoin and azelaic acid.
 - If you have taken any form of isotretinoin Accutane or Roaccutane in the last six months. This treatment can make skin more susceptible to tears, wounds and irritations.
 - If you are on painkillers which reduce the skin's sensitivity to heat.
 - If you are taking photosensitising agents or medications, check the package insert of your medicine and never use the device if it is stated that it can cause photo-allergic reactions, photo-toxic reactions or if you have to avoid sun when taking this medicine.
 - If you take anticoagulation medications, including heavy use of aspirin, in a manner which does not allow for a minimum 1-week washout period prior to each treatment.
- If you take immunosuppressive medications.
- Never use the device on the following areas:
 - Around the eyes and near the eyebrows.
 - On nipples, areolas, labia minora, vagina, anus and the inside of the nostrils and ears.
 - Men must not use it on the scrotum and face.
 - Over or near anything artificial like silicone implants, pacemakers, subcutaneous injection ports (insulin dispenser) or piercings.
 - On moles, freckles, large veins, darker pigmented areas, scars, skin anomalies without consulting your doctor. This can result in a burn and a change in skin color, which makes it potentially harder to identify skin-related diseases.



- On warts, tattoos or permanent make-up. This can result in a burn and a change in skin color.
- On areas, where you use long-lasting deodorants. This can result in skin reactions.
- Never use the device on sunburned, recently tanned or fake-tanned skin.

Note: This list is not exhaustive. If you are not sure whether you can use the device, we advise you to consult a doctor.

Important

Danger



- Keep the device and the adapter dry.
- If the device is broken, do not touch any inner part to avoid electric shock.
- Never insert any objects into the device.

Warning

- This device is not intended for use by persons (including children) with reduced physical, sensory or mental capabilities, unless they have been given supervision or instruction concerning use of the device by a person responsible for their safety.
- Children should be supervised to ensure that they do not play with the device.
- The device is not intended for children under the age of 15 years. Teenagers aged between 15 and 18 years can use the device with the consent and/or assistance of their parents or the persons who have parental authority over them. Adults of 18 years and older can use the device freely.
- Always check the device before you use it. Do not use the device or adapter if it is damaged. Always replace a damaged part with one of the original type.
- The adapter contains a transformer. Do not cut off the adapter to replace it with another plug, as this causes a hazardous situation.
- Do not use the device if the UV filter of the light exit window is broken.
- Do not use the precision attachment if its filter is broken.

Caution



- This device is not washable. Never immerse the device in water and do not rinse it under the tap.
- For hygienic reasons, the device should only be used by one person.
- Use the device only at settings suitable for your skin type. Use at higher settings than those recommended can increase the risk of skin reactions and side effects.
- Only use the device for its intended purpose as shown in the user manual.
- Never use compressed air, scouring pads, abrasive cleaning agents or aggressive liquids such as petrol or acetone to clean the device.
- Always return the device to a service centre authorised by Philips for examination or repair. Repair by unqualified people could cause an extremely hazardous situation for the user.

Electromagnetic fields (EMF)

This Philips device complies with all applicable standards and regulations regarding exposure to electromagnetic fields.

How IPL works

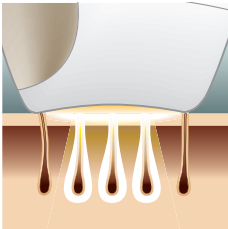

With IPL technology, gentle pulses of light are applied to the skin and absorbed by the hair root. The darker the hair, the better the pulses of light are absorbed.

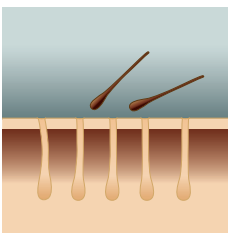

The pulses of light stimulate the hair follicle to go into a resting phase. As a consequence, the hair sheds naturally and hair regrowth is prevented, leaving your skin continuously silky-smooth.

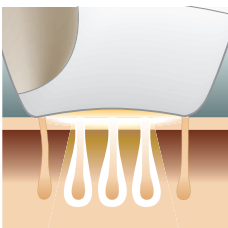

The cycle of hair growth consists of different phases. IPL technology is only effective when the hair is in its growing phase. Not all hairs are in the growing phase at the same time. This is why we recommend an 8-week treatment schedule followed by touch-ups to make sure all hairs are effectively treated in the growing phase..

Note: Treatment with Lumea is not effective if you have light blond, blond as light hairs do not absorb enough light. Below you can see the hair colors for which Lumea is suitable and effective.

Suitable body hair colors

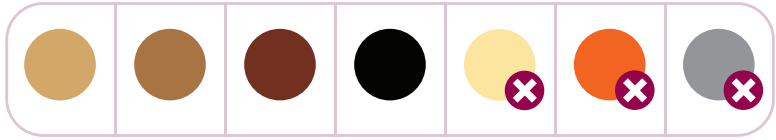

What to expect

Immediately after the 1st treatment

After the first treatment, it can take 1 to 2 weeks for the hairs to fall out. In the first weeks following the initial treatments, you still see some hairs growing. These are likely to be hairs that were not in their growing phase during the first treatments.

After 2-3 treatments

After 2-3 treatments, you should see a noticeable reduction in hair growth. However, to effectively treat all hairs, it is important to keep on treating according to the recommended treatment schedule.

After 4-5 treatments

After 4-5 treatments, you should see a significant reduction of hair growth in the areas that you treated with Lumea. A reduction of hair density should be visible as well. Keep on treating with frequent touch-ups (every 4-8 weeks) to maintain the result.

Tanning advice

Tanning with natural or artificial sunlight



Intentionally exposing your skin to natural or artificial sunlight with the aim of developing a tan influences the sensitivity and color of your skin.

Therefore the following is important:

- After each treatment, wait at least 48 hours before tanning. Even after 48 hours, make sure that the treated skin does not show any redness from the treatment anymore.
- In case of exposing your skin to the sun (without tanning intentionally) in the 48 hours after treatment, use a sunblock SPF 50+ on the treated areas. After this period, you can use a sunblock SPF 30+ for two weeks.
- After tanning, wait at least 2 weeks before you use Lumea. Perform a skin test to determine the appropriate light intensity setting.
- Do not use Lumea on sunburned body areas.

Note: Occasional and indirect sun exposure does not qualify as tanning.

Tanning with creams

If you have used an artificial tanning lotion, wait until the artificial tan has disappeared completely before you use the device.

Before you use your Lumea

Pretreating your skin

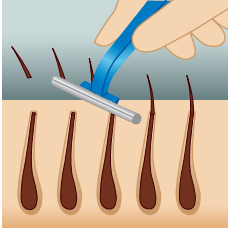

Before you use Lumea, you should pretreat your skin by removing hairs on the surface of your skin. This allows the light to be absorbed by the hair parts below the skin surface to ensure effective treatment. You can either shave, short-trim, epilate or wax. Do not use depilatory creams, as chemicals may cause skin reactions.



If you chose to wax, please wait 24 hours before using Lumea to let your skin rest. We recommend that you take a shower before the treatment to ensure that all possible residue of wax has been removed from your skin.

- 1 Pretreat the areas you intend to treat with Lumea.
- 2 Clean your skin and make sure it is hair-free, entirely dry and free from oily substances.

Note: Once the hairs stop growing back, which usually happens after 4-5 treatments, you no longer have to pretreat your skin before you use the device.

Skin test

When you use Lumea for the first time or after recent tanning, perform a skin test on each area to be treated. The skin test is necessary to check your skin's reaction to the treatment and to determine the correct light intensity setting for each body area.

- 1 Choose an area close to the area you intend to treat.
- 2 Turn on the device. Make sure you select setting 1.
- 3 Put the device against your skin and press the flash button to release a flash.
- 4 Slide the device over the skin to the next area to be treated.
- 5 Increase the setting by one level, apply a flash and slide the device to the next area. Repeat this for all levels within the recommended range for your skin type.
- 6 After the skin test, wait 24 hours and check your skin for any reaction. If your skin shows reactions, choose the highest setting that did not result in any skin reaction for subsequent use.

Using your Philips Lumea

Skin tone sensor

For extra safety the integrated skin tone sensor measures the skin tone at the beginning of each session and occasionally during the session. If it detects a skin tone that is too dark for treatment with Lumea, the device automatically disables to prevent you from developing skin reactions. This means that it does not emit pulses when you press the flash button.

Attachments

Placing and removing

To place the attachment, simply snap it onto the light exit window.

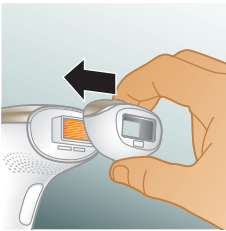

To remove the attachment, pull it off the light exit window.



Body attachment

You can use the body attachment to treat unwanted hair on several body areas below the neckline. You can use it for example for fast treatment of larger areas like legs.

Precision attachment

The precision attachment includes an additional integrated light filter for extra safety and you can therefore use it to treat unwanted facial hair on the upper lip, chin and sideburns. You can also use the precision attachment to easily treat hard to reach areas such as toes, bikini area or armpits. However, do not treat your eyebrows with Lumea.

Selecting the right light intensity

Lumea provides 5 different light intensities. Depending on your skin type and light intensity level you find comfortable, you can select the right light intensity setting.

- 1 Consult the table below to select the right setting.

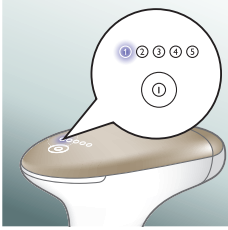

- To adjust the light intensity setting, press the on/off button one or more times until you have reached the required setting. The corresponding intensity light lights up white.

Note: The device automatically disables when your skin tone is too dark, to prevent you from developing skin reactions. The integrated skin tone sensor does not tell you which light intensity setting to use, as Philips Lumea gives you the freedom to select the light intensity that you find most convenient.

- Lumea should never be painful. If you experience discomfort, reduce the light intensity setting.
- After recent tanning, perform a skin test to determine the right light intensity setting.

Skin type	Skin tone	Light intensity setting
I	White; You always sunburn, never tan.	4/5
II	Beige; You easily sunburn, tan minimally.	4/5
III	Light brown; You sunburn easily, tan slowly to light brown.	4/5
IV	Mid brown; You rarely sunburn, tan easily.	3/4
V	Dark brown; You rarely sunburn, tan very easily.	You cannot use the device
VI	Brownish black or darker; You rarely or never sunburn, very dark tanning.	You cannot use the device



Note: Your skin may react differently on different days/occasions for a number of reasons.

Handling the device

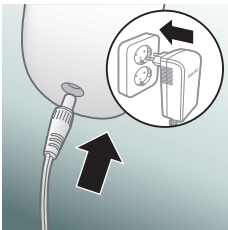

- Before use, clean the attachments and the light exit window.
- Put the small plug in the device and put the adapter in the wall socket.
- Switch on the device and select the right light intensity for your skin tone.

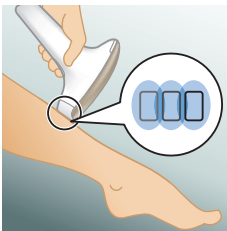
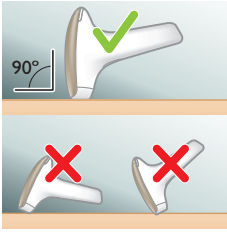

4 Place the device at a 90° angle on the skin so that the attachment and the integrated safety system are in contact with your skin. The integrated safety system prevents unintentional flashing without skin contact.

5 Press the device firmly onto your skin to ensure proper skin contact. The device then automatically performs a skin tone analysis and the 'ready to flash light' lights up white to indicate that you can proceed with the treatment.

Note: When the 'ready to flash' light lights up orange, your skin is not suitable for treatment. In this case, the device automatically disables. You can try to use the device on other areas with a lighter skin tone.

TIP: If you use Lumea on your bikini area and want to leave some hair in place, make sure that the skin tone sensor is not placed on the remaining hair during the treatment, as this can cause the device to block.

6 Press the flash button to release a flash. You should feel a warm sensation because of the flash.

Note: The light produced by the device is harmless to your eyes. It is not necessary to wear goggles during use. Use the device in a well-lit room so that the light is less glaring to your eyes.

7 Place the device on the next area to be treated. After each flash, it takes up to 3.5 seconds until the device is ready to flash again. You can release a flash when the 'ready to flash' light lights up again.

8 To make sure that you have treated all areas, release the flashes close to each other. Effective light only comes out of the light exit window, therefore there should be some overlap. However, make sure you flash the same area only once. Flashing the same area twice doesn't improve the effectiveness of the treatment, but increases the risk of skin reactions.

9 When you have finished the treatment, press and hold the on/off button for 2 seconds to switch off the device.

Two treatment modes: Stamp & Flash and Slide & Flash

Your Philips Lumea has two treatment modes for more convenient use on different body areas:

- The Stamp & Flash mode is ideal to treat small or curvy areas like knees and underarms. Simply press and release the flash button to release a single flash.
- The Slide & Flash mode offers convenient use on larger areas like legs. Keep the flash button pressed while you slide the device over your skin to release several flashes in a row.

Recommended treatment schedule

Initial phase

For the first 4 to 5 treatments, we advise you to use Philips Lumea once every two weeks to ensure that all hairs are treated.

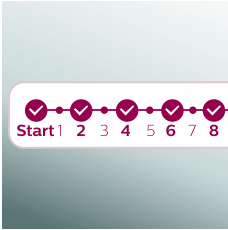

Touch-up phase

After the initial treatment phase (4-5 treatments), we recommend touch-ups every 4 to 8 weeks, when you see hairs growing back. This is to maintain results and enjoy smooth skin for months. The time between treatments may vary based on your individual hair regrowth and also across different body areas.

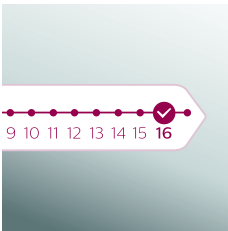

Recommended attachment & treatment time per area

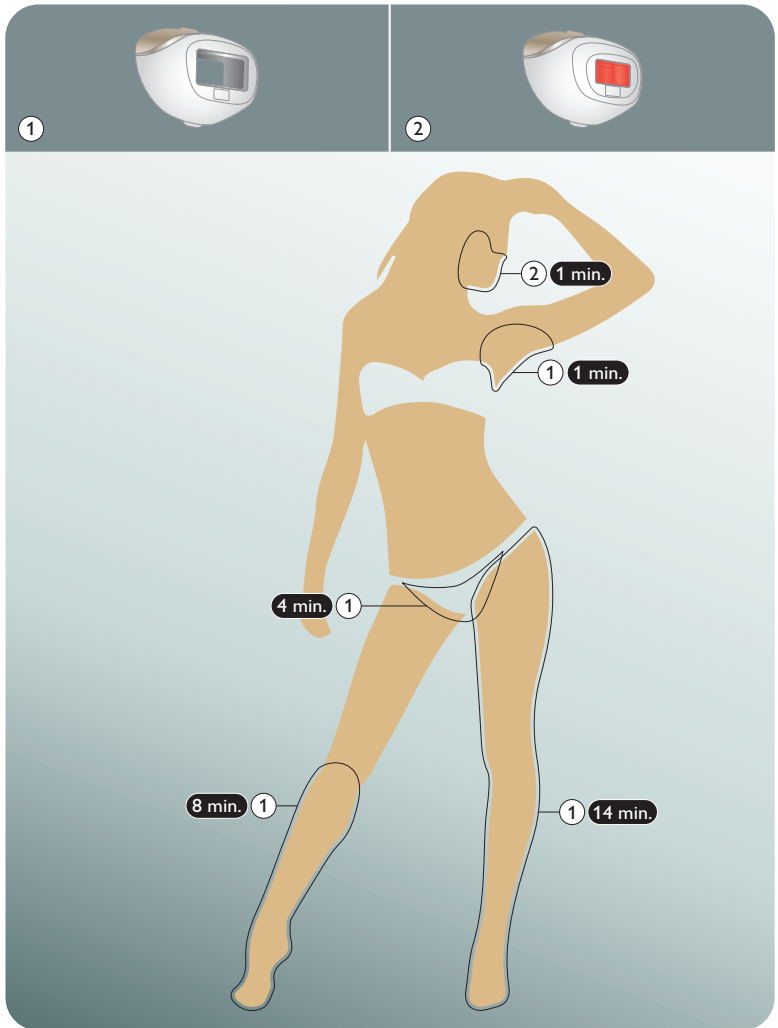

After use

Common skin reactions

Your skin may show slight redness and/or may prickle, tingle or feel warm. This reaction is absolutely harmless and disappears quickly.

Dry skin and itching may occur due to shaving or a combination of shaving and light treatment. You can cool the area with an ice pack or a wet face cloth. If dryness persists, you can apply a non-scented moisturizer on the treated area 24 hours after the treatment.

Rare side effects

- Burns, excessive redness and swelling: these reactions occur very rarely. They are the result of using a light intensity that is too high for your skin tone. If these reactions do not disappear within 3 days, we advise you to consult a doctor. Wait with the next treatment until the skin has healed completely and make sure you use a lower light intensity.
- Skin discoloration: this occurs very rarely. Skin discoloration manifests itself as either a darker patch (hyperpigmentation) or a lighter patch (hypopigmentation) than the surrounding area. This is the result of using a light intensity that is too high for your skin tone. If the discoloration does not disappear within 2 weeks, we advise you to consult a doctor. Do not treat discolored areas until the discoloration has disappeared and your skin has regained its normal skin tone.
- Skin infection and inflammation: This occurs very rarely and may be caused by using the device on wounds or cuts that resulted from shaving, on already existing wounds or on ingrown hairs.
- Excessive pain: this can occur during or after treatment if you have used the device on skin that is not hair-free, if you use the device at a light intensity that is too high for your skin tone, if you flash the same area more than once and if you use the device on open wounds, inflammations, infections, tattoos, burns, etc.

Aftercare

After use, you can safely apply lotions, creams, deodorant, moisturizer or cosmetics to the treated areas. If you experience skin irritation or skin redness after treatment, wait until it disappears before applying any product to your skin. If you experience skin irritation after applying a product to your skin, wash it off with water.

Cleaning & storage

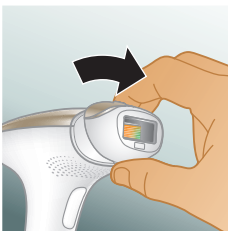

- 1 After use, switch off the device, unplug it and let it cool down.
- 2 Remove the attachment.

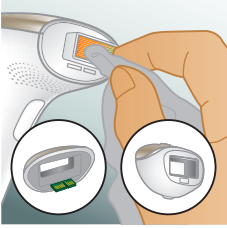

- 3 Moisten the soft cloth supplied with the device with a few drops of water and use it to clean the following parts:
 - the light exit window
 - the outside surface of the attachments
 - the reflector inside the attachments
 - the reddish filter glass inside the precision attachment.
- 4 Let all parts air dry thoroughly.
- 5 Store the device in a dust-free and dry place at a temperature between 0 °C and 60 °C.

Guarantee and support

If you need information or support, please visit www.philips.com/support or read the separate worldwide guarantee leaflet.

Recycling



- This symbol means that this product shall not be disposed of with normal household waste (2012/19/EU).
- Follow your country's rules for the separate collection of electrical and electronic products. Correct disposal helps prevent negative consequences for the environment and human health.

Technical specifications

Rated voltage	100V-240V
Rated frequency	50Hz-60Hz
Rated input	36W
Protection against electric shock	Class II
Protections rating	IP 30 (EN 60529)
Operating conditions	Temperature: +15 °C to 35 °C
	Relative humidity: 30% to 95%
Spectrum of body attachment	>530nm
Spectrum of precision attachment	>600nm

Troubleshooting

This chapter summarizes the most common problems you could encounter with the device. If you are unable to solve the problem with the information

below, visit www.philips.com/support for a list of frequently asked questions or contact the Consumer Care Center in your country.

Problem	Possible cause	Solution
The device/adapter becomes warm during use	This is normal.	No action required.
When I place the device on the skin it does not release a flash. The 'ready to flash light' blinks orange and then lights up orange continuously.	You skin tone in the area to be treated is too dark.	Treat other body areas with lighter skin tones with Lumea.
The 'ready to flash light' doesn't light up when I place the attachment on my skin, but the cooling fan works.	The overheat protection has been activated.	When the overheat protection has been activated, the fan still works. Do not switch off the device, but let it cool down for approx. 15 minutes before you continue to use it.
The 'ready to flash light' lights up white but the device does not produce a flash when I press the flash button.	The device needs to be reset.	To reset the device, switch it off and switch it on again.
I cannot increase or decrease the light intensity settings/All intensity lights are blinking alternately	The device needs to be reset.	To reset the device, switch it off and switch it on again.
The device produces a strange smell.	The attachment or the filter glass is dirty.	Clean the attachment carefully.
	You have not removed the hairs on the area to be treated properly. These hairs may get burned and can cause the smell.	Pretreat your skin before you use Lumea.
The skin feels more sensitive than usual during treatment/ I experience an unacceptable pain sensation when I use the device.	The light intensity setting you use is too high.	Check if you have selected the right light intensity setting. If necessary, select a lower setting.
	You did not remove the hairs on the areas to be treated.	Pretreat your skin before you use Lumea.
	The UV filter of the light exit window is broken.	If the UV filter is broken, do not use the device anymore. Contact the Consumer Care Center in your country, your Philips dealer or a Philips service center.
	You treated an area for which the device is not intended.	Never use the device on the following areas: inner labia, anus, nipples, areolas, lips, inside the nostrils and ears, around the eyes and near the eyebrows. Men must not use it on the face or on the scrotum.
The skin reaction after treatment last longer than usual.	You have used a light intensity setting which is too high for you.	Select a lower intensity next time. See chapter 'Using your Philips Lumea', section 'Selecting the right light intensity'..

Problem	Possible cause	Solution
The results of the treatment are not satisfactory.	You have used a light intensity setting which is too low for you.	Select a higher setting next time.
	You did not flash an area adjacent to an area you treated before.	You have to release the flashes close to each other.
	The device is not effective on your body hair color.	If you have light blond, blond, or red hair, the treatment is not effective.
	You do not use the device as often as recommended.	To remove all hairs successfully, we advice you to follow the recommended treatment schedule. You can reduce the time between treatments, but do not treat more often than once every two weeks.
	You respond more slowly to IPL treatment.	Continue using the device for at least 6 months, as hair regrowth can still decrease over the course of this period.
My body attachment does not have an integrated glass/filter/window.	This is normal.	The body attachment does not contain a glass/filter/window.



© 2015 Koninklijke Philips N.V. All rights reserved. Specifications are subject to change without notice. Trademarks are the property of Koninklijke Philips N.V. (Royal Philips) or their respective owners.

www.philips.com
4222.100.5166.1