

Register your product and get support at
www.philips.com/welcome

HP6368, HP6366



PHILIPS



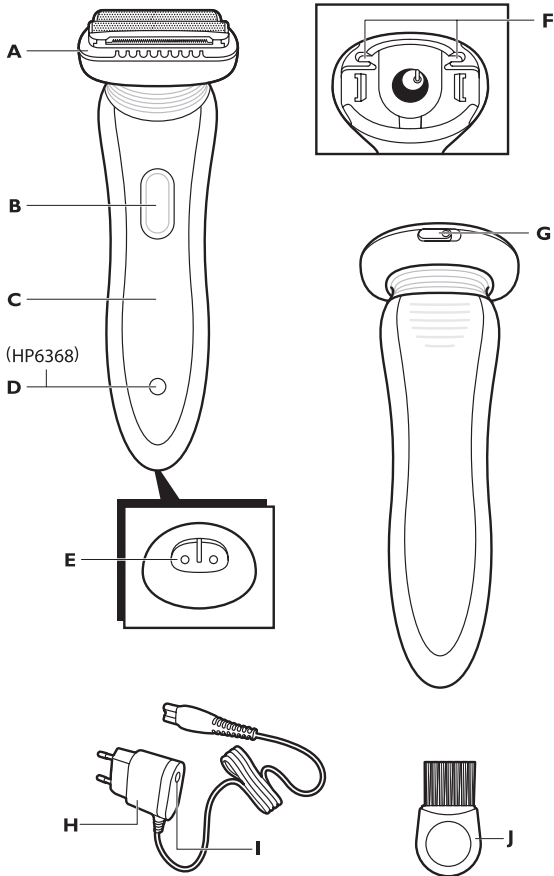

Introduction

Congratulations on your purchase and welcome to Philips! To fully benefit from the support that Philips offers, register your product at www.philips.com/welcome.

With its 'skin protection system', Ladyshave Sensitive protects your skin while providing you with beautifully smooth results. Its double foil pivoting head makes light work of even the toughest hairs, without fear of nicks and cuts.

You can use the Ladyshave Sensitive either dry or wet. It's a cordless appliance with a rechargeable battery.

General description (Fig. 1)

- A** Shaving head with cutting unit (trimmer; aloe vera strip, gentle hair lifter and double shaving foil)
- B** On/off button
- C** Handle
- D** Battery-low light (HP6368 only)
- E** Socket for appliance plug
- F** Guiding grooves
- G** Cutting unit release slide
- H** Adapter
- I** Charging light
- J** Cleaning brush

Not shown: Storage pouch (HP6368 only)

Important

Read this user manual carefully before you use the appliance and save it for future reference.

Danger

- Keep the adapter dry.

Warning

- Only use the Ladyshave with the adapter supplied.
- Do not use the appliance, an attachment or the adapter if it is damaged or broken to avoid injuries.

- If the adapter is damaged, always have it replaced with one of the original type in order to avoid a hazard.
- The adapter contains a transformer. Do not cut off the adapter to replace it with another plug, as this causes a hazardous situation.
- This appliance is not intended for use by persons (including children) with reduced physical, sensory or mental capabilities, or lack of experience and knowledge, unless they have been given supervision or instruction concerning use of the appliance by a person responsible for their safety.
- Children should be supervised to ensure that they do not play with the appliance.
- Do not insert metal-containing material into the socket for the appliance plug to avoid short circuiting.

Caution

- Do not clean the Ladyshave with water that is hotter than shower temperature (max. 40°C).
- Charge, use and store the appliance at a temperature between 10°C and 40°C.
- This appliance is only intended to be used by women to shave their body hair. It is not intended for shaving scalp hair or for any other purpose.
- Only use the shaving head on the legs, the arms, the underarms and the bikini area. Never use the shaving head on other body areas (e.g. the face).
- Make sure the socket is live when you charge the appliance. The electricity supply to sockets in mirror cabinets over washbasins or shaver sockets in bathrooms may be cut off when the light is turned off.

General

- The appliance complies with the internationally approved IEC safety regulations and can be safely used in the bath or shower and cleaned under the tap (Fig. 2).

Electromagnetic fields (EMF)

This Philips appliance complies with all standards regarding electromagnetic fields (EMF). If handled properly and according to the

instructions in this user manual, the appliance is safe to use based on scientific evidence available today.

Preparing for use

Charging

It takes approximately 10 hours to charge the batteries fully. When the batteries are fully charged, the appliance has a cordless shaving time of up to 40 minutes.

Always switch off the appliance before you connect it to the mains.

- 1 Insert the appliance plug into the appliance (1). Plug the adapter into a wall socket (2) (Fig. 3).
- ▶ The charging light on the adapter goes on.

Note: The charging light on the adapter remains on after the appliance is fully charged.

Note: Do not leave the adapter plugged in for longer than 14 hours, as this may affect the lifetime of the batteries.

Rechargeable batteries low or empty (HP6368 only)

- If the batteries run low during use, the battery low light lights up. You can continue to shave for a few minutes. (Fig. 4)
- When the batteries are empty, the battery-low light goes out and the appliance stops. Charge the batteries immediately.
- When you switch off the appliance while the batteries are low, the battery-low light flashes 4 times.

Attaching/detaching the shaving head

- 1 To attach the shaving head, slide it into the guiding grooves on both sides of the opening in the handle. Then press the shaving head onto the appliance ('click') (Fig. 5).
- 2 To detach the shaving head, pull it off the appliance (Fig. 6).

Caution: Do not exert excessive pressure on the double shaving foil to avoid damage.

Using the appliance

Make sure that the appliance is fully charged before you use it for the first time.

Note: You cannot use the Ladyshave while it is connected to the mains.

Shaving

Note: When you use the appliance for shaving, you can use it under both dry and wet conditions.

- 1** Place the double shaving foil and the integrated trimmer gently on the skin. Stretch the skin with your free hand while you shave your bikini line. (Fig. 7)

Note: Do not press the appliance too firmly onto the skin.

Note: When you shave the underarms, raise your arm to stretch the skin.

- 2** Move the appliance slowly over the skin against the direction of hair growth. Make sure that the trimmer and the double shaving foil are always in full contact with the skin (Fig. 8).

Note: If you move the appliance over the skin too fast, you may not obtain a smooth result.

Tip: To achieve the best result when you shave wet, lather your skin with soap or shaving cream before you start to shave.

Caution: Never apply any cream or foam before you start to shave under dry conditions.

Cleaning and maintenance

Always switch off and unplug the appliance before you clean it.

Never switch on the appliance while you clean it or while the cutting unit is not attached.

Never use scouring pads, abrasive cleaning agents or aggressive liquids such as petrol or acetone to clean the appliance.

Cleaning the shaving head

1 Press the on/off button to switch off the appliance (Fig. 9).

2 Pull the shaving head off the appliance (Fig. 6).

Do not exert pressure on the double shaving foil to avoid damage.

3 Push the cutting unit release slide to the right (1) and remove the cutting unit (2) (Fig. 10).

4 Clean the cutting unit and the inside of the shaving head with the cleaning brush. Also brush away any hairs that have collected under the trimmer (Fig. 11).

Caution: Do not brush the foil to avoid damage to the brush or the foil.

5 You can also rinse the cutting unit and the shaving head under the tap. To dry the cutting unit and the shaving head, shake them firmly. (Fig. 12)

6 Place the cutting unit back onto the shaving head ('click') (Fig. 13).

Note: Make sure that the shaving head and the cutting unit are completely dry before you reattach them onto the appliance.

Maintenance

1 Lubricate the cutting unit (double shaving foil and trimmer) with a drop of sewing machine oil twice a year (Fig. 14).

2 Let the appliance operate briefly to spread the oil.

Replacement

The shaving head and the adapter of the appliance can be replaced. If you need to replace one or more parts, go to your Philips dealer or an authorised Philips service centre. If you use the Ladyshave two or more times a week, we advise you to replace the shaving head after one or two years or if it is damaged.

Storage

- 1 Store the appliance in a safe, dry place.

Environment

- Do not throw away the appliance with the normal household waste at the end of its life, but hand it in at an official collection point for recycling. By doing this, you help to preserve the environment (Fig. 15).
- The built-in rechargeable batteries contains substances that may pollute the environment. Always remove the batteries before you discard and hand in the appliance at an official collection point. Dispose of the batteries at an official collection point for batteries. If you have trouble removing the batteries, you can also take the appliance to a Philips service centre. The staff of this centre will remove the batteries for you and will dispose of them in an environmentally safe way (Fig. 16).

Removing the rechargeable batteries

- 1 Disconnect the appliance from the adapter. Let the appliance run until the batteries are completely empty. Remove the shaving head from the appliance.
- 2 Release the side panels on both sides of the appliance with a screwdriver and remove them (Fig. 17).
- 3 Remove the front panels of the appliance by pushing them upwards with a screwdriver (Fig. 18).

12 ENGLISH

- 4 Cut the wires at the end of the handle and pull out the inner part. Take out the rechargeable batteries. (Fig. 19)

Do not try to replace the rechargeable batteries.

Do not connect the appliance to the mains again after you have removed the rechargeable batteries.

Guarantee and service

If you need service or information or if you have a problem, please visit the Philips website at www.philips.com or contact the Philips Consumer Care Centre in your country. You find its phone number in the worldwide guarantee leaflet. If there is no Consumer Care Centre in your country, go to your local Philips dealer.

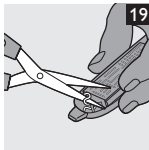
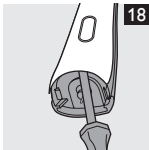
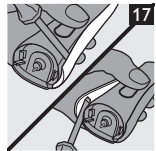
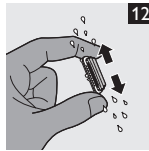
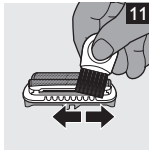
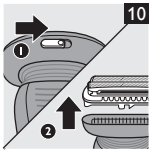
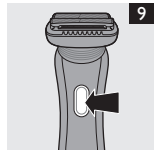
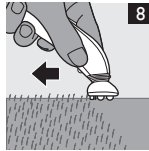
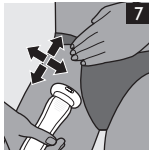
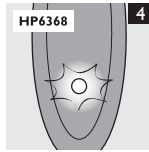
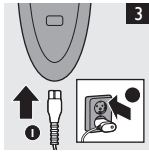
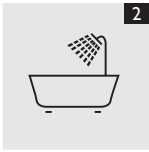





www.philips.com



100% recycled paper
100% papier recyclé

4203.000.6703.3